

**SPECIFICATION**

Current Rate:3 AMP  
Insulation Resistance:1000M Ω Min.  
Contact Resistance:20m Ω Max.  
Dielectric Voltage:1000V AC for one minute  
Operation Temperature:-40°C to +105°C

**MATERIAL**

Insulator:Polyester,UL 94V-0  
Standard:PBT or Nylon 6T  
Contact Pin:Copper Alloy  
Contact Plating:Gold Flash all over

Standart height (H) = 2.5

**PLS-xx**

**Pin Header 2.54mm 1 Row H=1.5/1.7/2.5mm Straight Type**

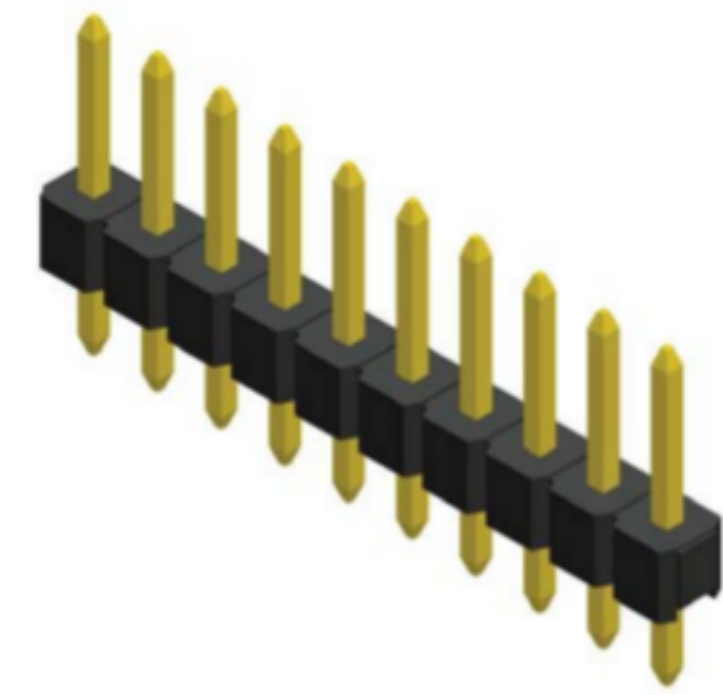
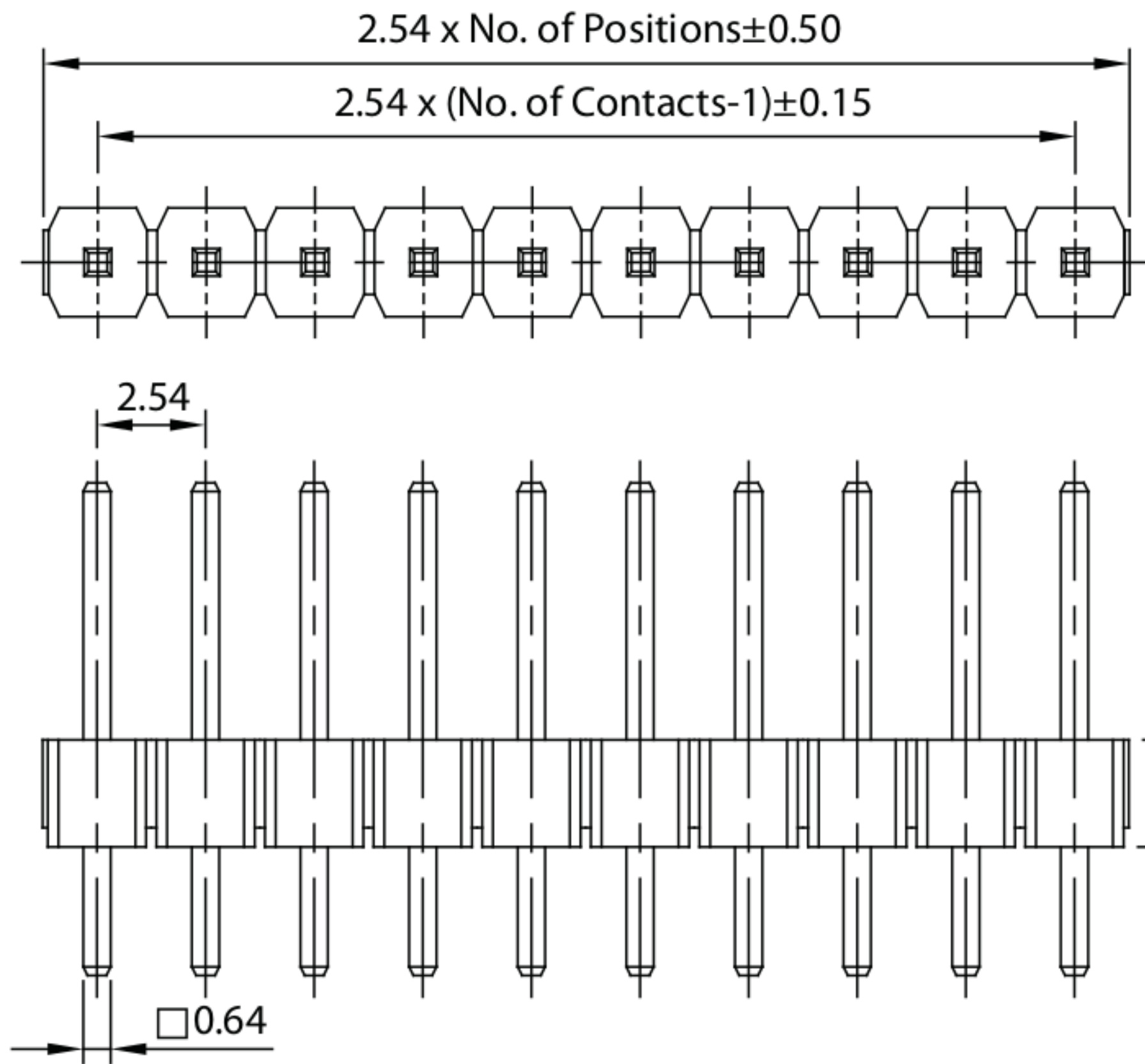

Recommended PCB Layout  
(PCB TOLERANCE  $\pm 0.05$ )

**PLD-xx**

**Pin Header 2.54mm 2 Row H=1.5/1.7/2.5mm Straight Type**

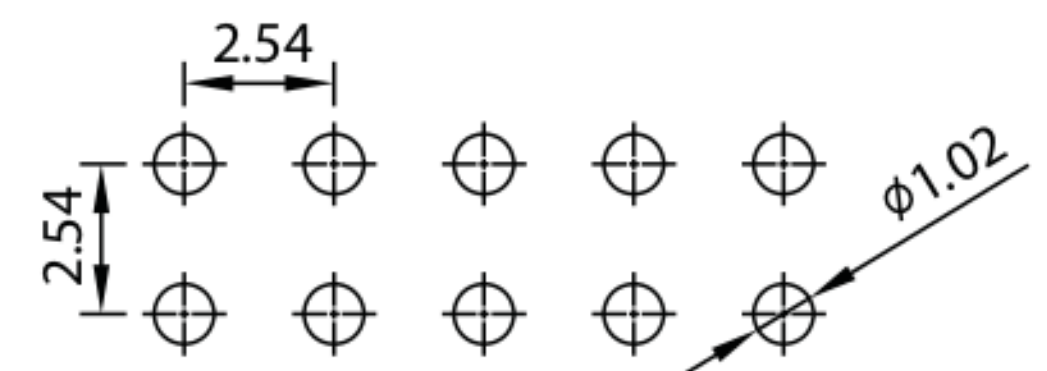
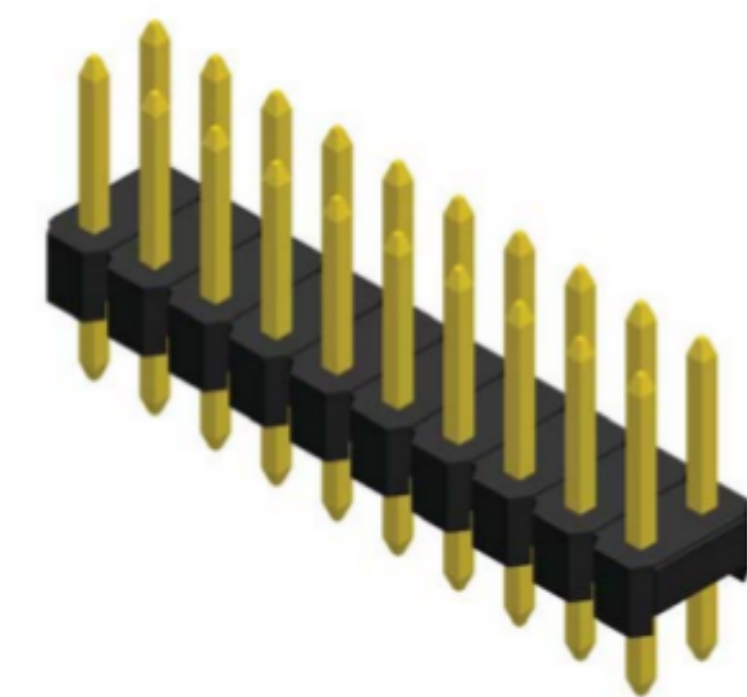
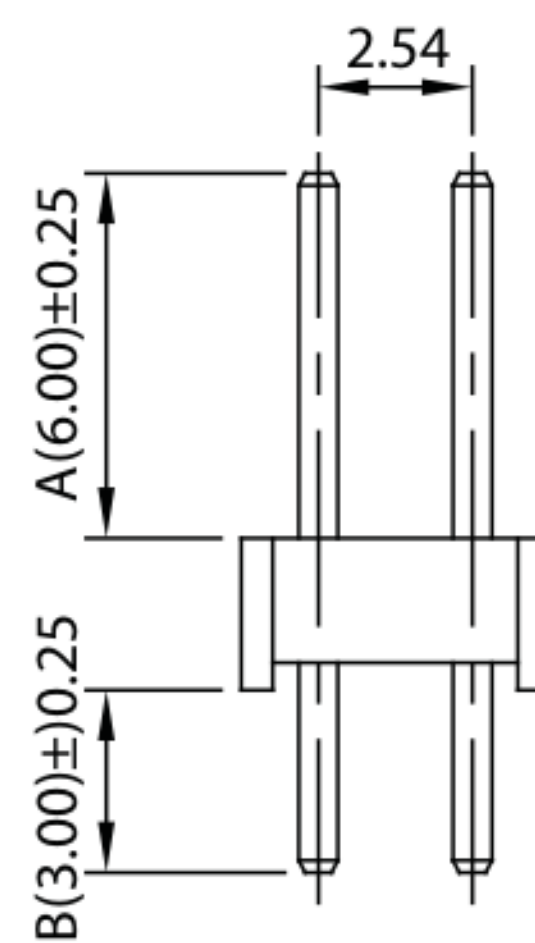
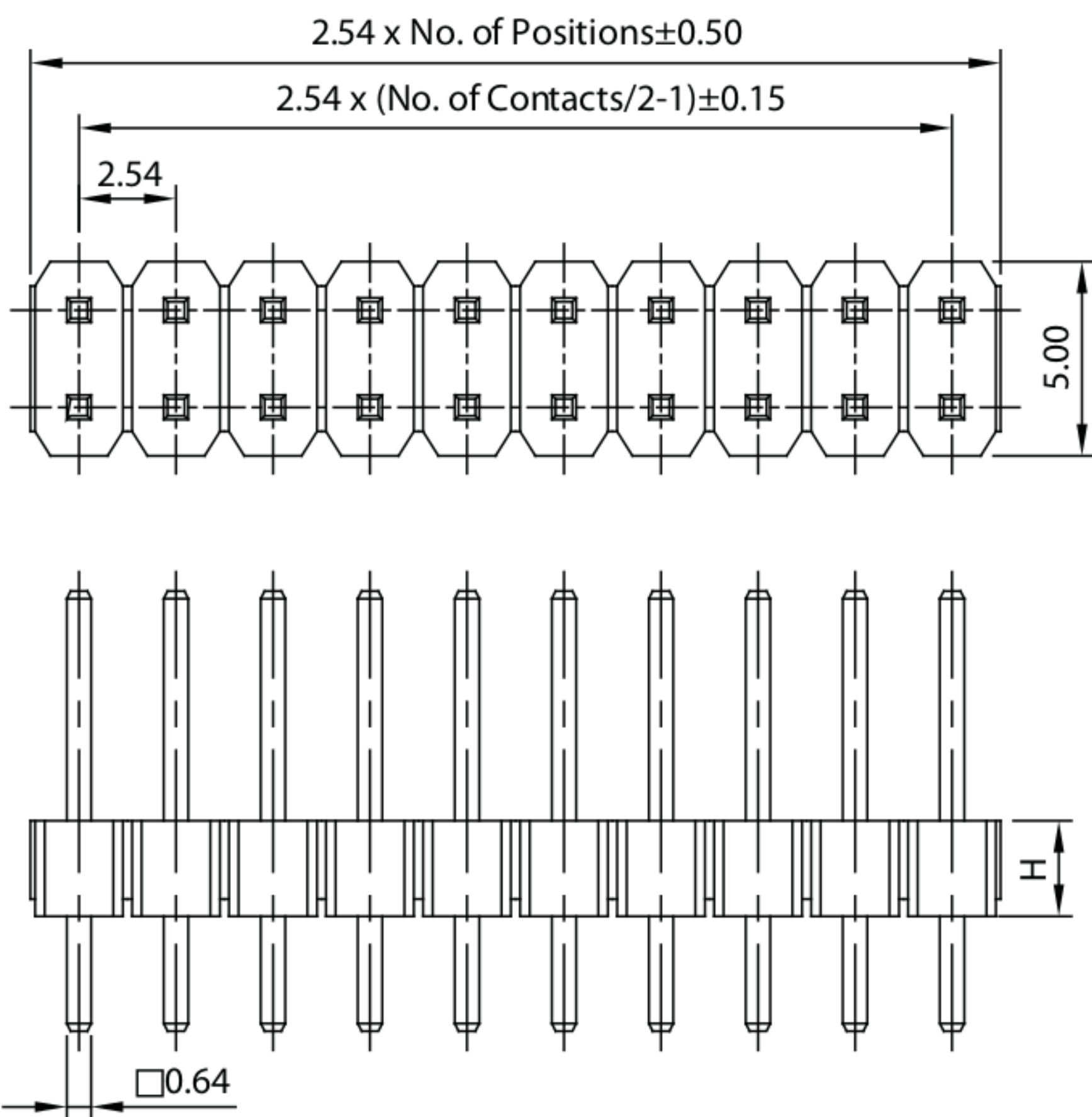

Recommended PCB Layout  
(PCB TOLERANCE  $\pm 0.05$ )