

# TRC

## MAIN FEATURES

- Smallest size (10.2 × 18.2 × 14.8 mm) at 10A switching capacity relay for high density P.C. board mounting technique.
- 1A and 1C contact form available.
- Surge resistiveness of 5000V on series relays.
- Design conforms to foreign safety standard (UL/CSA/TUV).
- Selection of plastic insulation material for high temperature and better chemical solution performance.

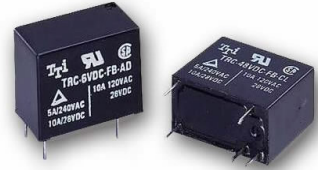

## APPLICATIONS

- Domestic appliance, office machine, audio equipment, automobile, etc.

## ORDERING INFORMATION

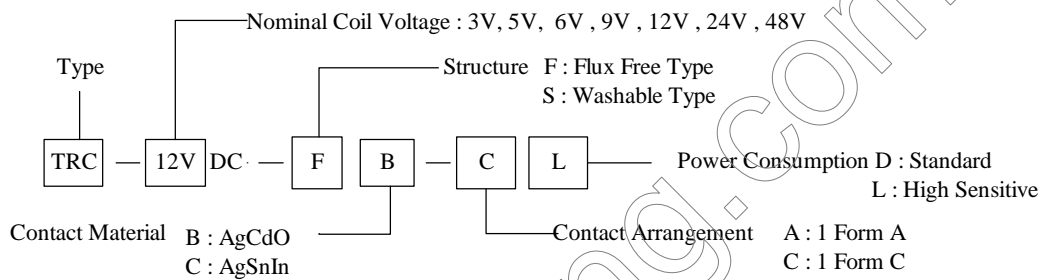

## DIMENSION (unit:mm)

## DRILLING (unit:mm)

## WIRING DIAGRAM

### 1 Form A

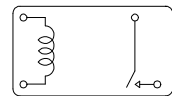
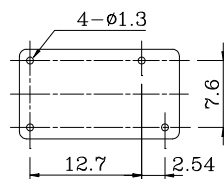
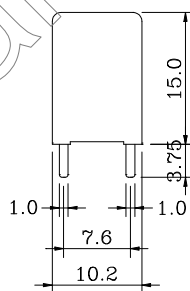
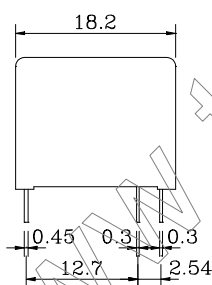

### 1 Form C

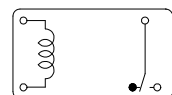
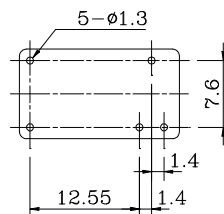
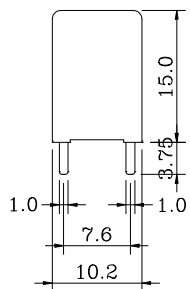
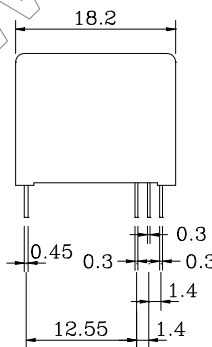

## COIL DATA CHART (AT20°C)

Coil Sensitivity	Coil Voltage Code	Nominal Voltage (VDC)	Nominal Current (mA)	Coil Resistance ( $\Omega$ ) $\pm 10\%$	Power Consumption (W)	Pull-In Voltage (VDC)	Drop-Out Voltage (VDC)	Max-Allowable Voltage (VDC)
TRC-L (High Sensitivity)	03	3	67	45	abt. 0.2W	75% Max.	5% Min.	130% Max.
	05	5	40	125				
	06	6	33.3	180				
	09	9	22.5	400				
	12	12	16.7	720				
	24	24	8.16	2800				
TRC-D (Standard)	03	3	150	20	abt. 0.45W	75% Max.	5% Min.	120% Max.
	05	5	91	55				
	06	6	75	80				
	09	9	50	180				
	12	12	37.5	320				
	24	24	18.8	1280				
	48	48	9.4	5100				

### CONTACT RATING

Item	Type	TRC	
		D Type	L Type
Contact Capacity			
Resistive Load ( $\cos\Phi=1$ )		10A 120VAC 10A 28VDC	7A 120VAC 7A 28VDC
Inductive Load ( $\cos\Phi=0.4$ L/R=7msec)		4A 120VAC 4A 28VDC	2A 120VAC 2A 28VDC
Rated Carrying Current		10A	7A
Max. Allowable Voltage		265VAC, 30VDC	
Max. Allowable Current		10A	7A
Max. Allowable Power Force		1200VA, 240W	840VA, 100W
Referenced Min. Applicable Load		5VDC, 10mA	
Contact Material		Ag Alloy	

### PERFORMANCE (at initial value)

Item	Type	TRC	
		1 Form C	1 Form A
Contact Resistance		100m $\Omega$ Max.	
Operation Time		10msec Max.	
Release Time		4msec Max.	
Dielectric Strength Between coil & contact Between contacts		2800VAC 1 minute 750VAC/min	3500VAC 1min
Surge Resistiveness		5000V	
Insulation Resistance		100 M $\Omega$ Min. (500VDC)	
Max. ON/OFF Switching Mechanically Electrically		300 operation/min 30 operation/min	
Operating Ambient Temperature		-30°C to +60°C	
Operating Humidity		45 to 85% RH	
Coil Temperature Rise		40 deg. Max. (at rated coil voltage)	
Vibration Endurance Error Operation		10 to 55HZ Double Amplitude 1.5mm 10 to 55HZ Double Amplitude 1.5mm	
Shock Endurance Error Operation		100G Min. 10G Min.	
Life Expectancy Mechanically Electrically		10 $\times$ 10 <sup>6</sup> ops. Min. (no load) 10 $\times$ 10 <sup>4</sup> ops. Min. (at rated coil voltage)	
Weight		abt. 6grs.	
UL File No.		E156521	
CSA File No.		LR102317	
TUV File No.		R9452084	

### REFERENCE DATA

Coil Temperature Rise

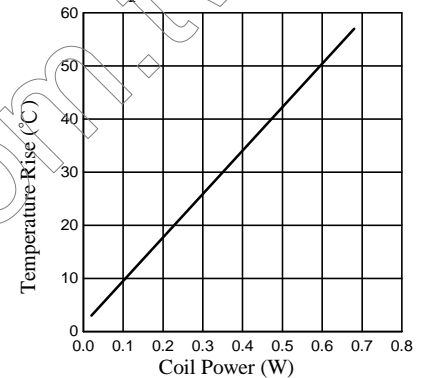

Operation Time

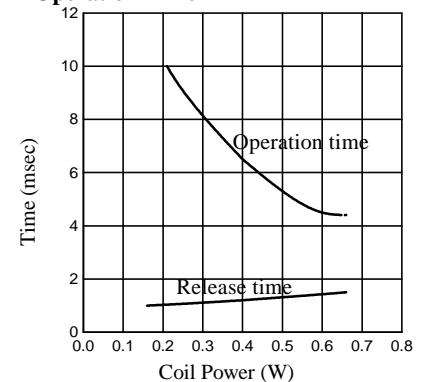

Life Expectancy

