

# LA100P Semiconductor Fuses

1000 VAC ■ Very Fast-Acting ■ 15 – 1000 Amperes

**NEW**



Littelfuse's LA100P semiconductor protection fuses are rated 1000V, extending the range of protection for UPS systems, AC and DC drives, reduced voltage motor starters and similar applications where lower  $I^2t$  and superior reliability are needed. With ratings from 15-1000 amperes, a wide range of high voltage applications can be served.

## FEATURES

- **Low  $I^2t$**  minimizes damage to protected components on short circuit.
- **Controlled arc voltage** reduces stress to circuit components during fuse clearing.

## APPLICATIONS

Protection of UPS systems, AC/DC drives, reduced voltage motor starters and other 1000V or less semiconductor devices.

## SPECIFICATIONS

- Voltage Rating:** AC: 1000 Volts  
DC: 750 Volts
- Interrupting Rating:** 100,000 Amperes
- Ampere Range:** 15 – 1000 Amperes
- Approvals:** UL Recognized under the components program.

## ORDERING INFORMATION

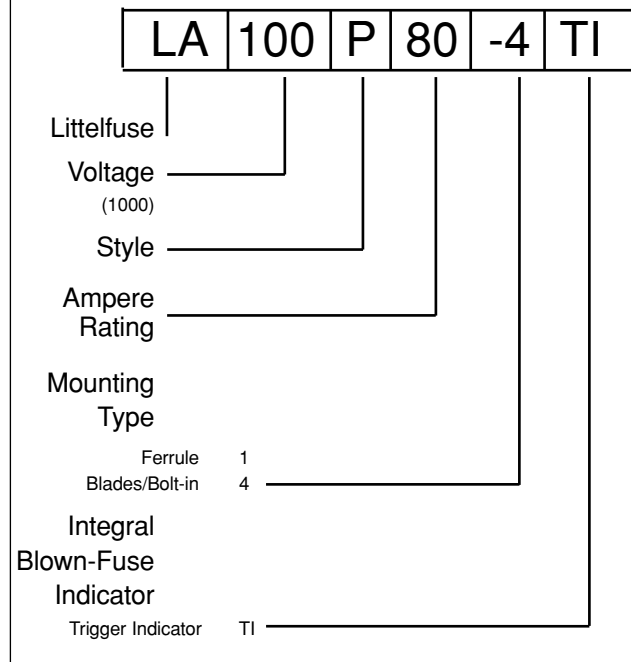

**Note:** Mounting types and integral blown fuse indicators are optional for specified ratings.

Special Purpose Fuses

# LA100P Semiconductor Fuses

1000 VAC ■ Very Fast-Acting ■ 15 – 1000 Amperes

## Catalog Numbers & Technical Data

Ampere Rating	Littelfuse Catalog Number	Mounting Type	Maximum Clearing I <sup>2</sup> t @1000 VAC (A <sup>2</sup> S x 10 <sup>3</sup> )	Watts Loss @ Rated Current (W)
15	LA100P15-1	1	0.6	3.4
20	LA100P20-1	1	0.8	5.9
25	LA100P25-1	1	1.3	9
30	LA100P30-1	1	1.5	12.8
35	LA100P35-4	4	2.2	7.3
40	LA100P40-4	4	2.9	8.3
50	LA100P50-4	4	4.5	11
50	LA100QP50-4TI	4TI	4.5	11
60	LA100P60-4	4	6.5	13
60	LA100P60-4TI	4TI	6.5	13
70	LA100P70-4TI	4TI	8.8	13
80	LA100P80-4	4	12	14
80	LA100P80-4TI	4TI	12	14
100	LA100P100-4	4	18	18
100	LA100P100-4TI	4TI	18	18
125	LA100P125-4	4	28	23
125	LA100P125-4TI	4TI	28	23
150	LA100P150-4	4	41	28
150	LA100P150-4TI	4TI	41	28

Ampere Rating	Littelfuse Catalog Number	Mounting Type	Maximum Clearing I <sup>2</sup> t @1000 VAC (A <sup>2</sup> S x 10 <sup>3</sup> )	Watts Loss @ Rated Current (W)
200	LA100P200-4	4	72	36
200	LA100P200-4TI	4TI	72	36
225	LA100P225-4	4	91	40
250	LA100P250-4	4	110	46
300	LA100P300-4	4	160	55
300	LA100P300-4TI	4TI	160	55
350	LA100P350-4	4	220	65
350	LA100P350-4TI	4TI	220	65
400	LA100P400-4	4	290	70
400	LA100P400-4TI	4TI	290	70
500	LA100P500-4	4	450	90
500	LA100P500-4TI	4TI	450	90
600	LA100P600-4	4	650	110
600	LA100P600-4TI	4TI	650	110
650	LA100P650-4	4	780	120
700	LA100P700-4	4	880	125
800	LA100P800-4	4	1200	140
800	LA100P800-4TI	4TI	1200	140
1000	LA100P1000-4	4	1900	190

FIGURE 1



FIGURE 2

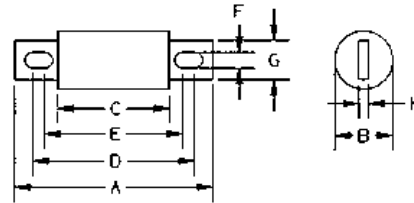

FIGURE 3

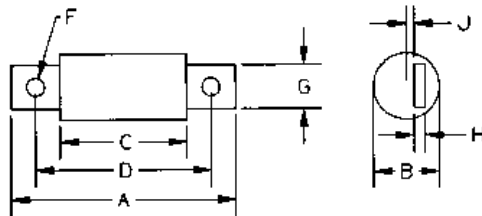
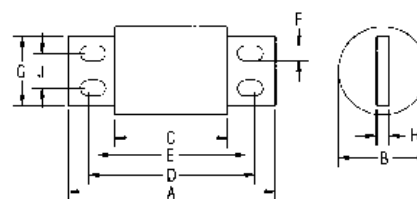

FIGURE 4



Special Purpose Fuses

## DIMENSIONS

Dimensions for reference only.

AMPERES	MOUNT. TYPE	FIG. NO.	DIMENSIONS IN INCHES (mm in parentheses)									
			A	B	C	D	E	F	G	H	J	
15 – 30	1	1	2.53 (66.8)	0.56 (14.2)	-	-	-	-	-	-	-	-
35 – 60	4, 4TI	2	5.00 (127)	1.00 (25.4)	3.50 (173)	4.31 (109)	4.19 (106)	0.31 (7.9)	0.75 (19.1)	0.13 (3.3)	-	-
65 – 100	4, 4TI	2	5.00 (127)	1.22 (31)	3.50 (173)	4.31 (109)	4.19 (106)	0.31 (7.9)	1.00 (25.4)	0.19 (4.8)	-	-
125 – 200	4, 4TI	2	5.72 (145)	2.00 (50.8)	3.47 (88.1)	4.78 (121)	4.16 (106)	0.41 (10.4)	1.00 (25.4)	0.25 (6.4)	-	-
225 – 400	4, 4TI	2	5.72 (145)	2.00 (50.8)	3.47 (88.1)	4.78 (121)	4.16 (106)	0.41 (10.4)	1.50 (38.1)	0.25 (6.4)	-	-
500 – 600	4, 4TI	2	7.72 (196)	2.50 (63.5)	3.47 (88.1)	5.88 (149)	5.56 (141)	0.53 (13.5)	2.00 (50.8)	0.38 (9.7)	-	-
650 – 800	4, 4TI	3	7.44 (189)	2.88 (73.2)	3.94 (100)	5.94 (151)	-	0.63 (16)	2.00 (50.8)	0.38 (9.7)	0.31 (7.9)	-
1000	4	4	8.22 (209)	3.50 (88.9)	4.47 (114)	6.59 (167)	5.84 (148)	0.63 (16)	2.75 (69.9)	0.50 (12.7)	1.38 (35.1)	-

Contact Littelfuse for characteristic curves.